

DIF

Applications

Secondary filtration, safety filtration. The disk filter allows high efficiency and filtration precision. Thanks to the excellent UV ray resistance, it can be installed outdoors without any protection.

Materials

- Body: polyamide reinforced with fibre glass
- Cover: polyamide reinforced with fibre glass
- Closure element: stainless steel ring AISI 304
- Filtering element:
 - mesh in stainless steel AISI 304 with polypropylene structure
 - polypropylene disks
- Gaskets: NBR
- Disks support: glass reinforced polyamide



Characteristics

- Maximum working pressure: 10 bar at 20°
- Standard filtration grade: 120 mesh
(filtration available: 50, 80, 120, 150, 200 mesh)
- Types of connection: threaded, victaulic or flanged
- Manometer coupling: Ø1/4" female
- Installation: on line

Load loss*

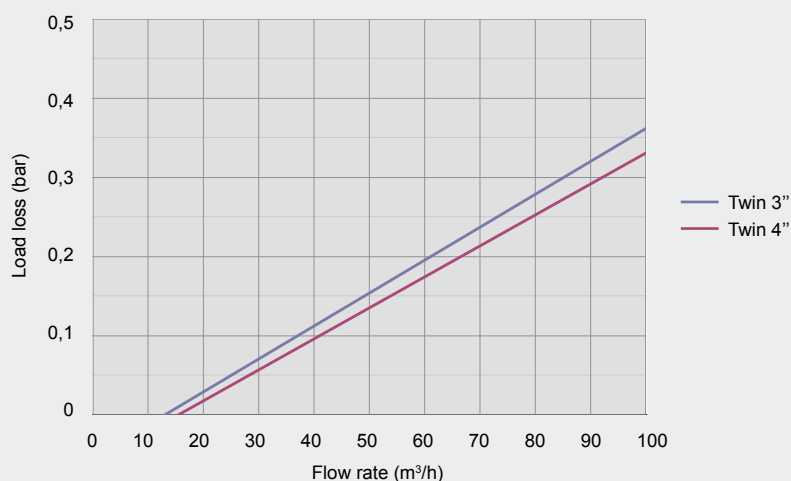

*Testing for load loss was carried out with clean water.

DIF

Technical data

Couplings	Pricelist ref.	Filtering cartridge	Connections	Rec. max. flow rate (m ³ /h)	Filtration area (cm ²)
4"	IFDIFLILM2F0N	s.s.	threaded	100	3736
	IFDIFLDLM2F0N	disk			
	IFDIFLELM2F0N	Rotodisk™			
	IFDIFLILW0F0N	s.s.			
	IFDIFLDLW0F0N	disk	victaulic		
DN 100	IFDIFLELW0F0N	Rotodisk™	flanged	100	3736
	IFDIFLILF0F0N	s.s.			
	IFDIFLDLF0F0N	disk			
	IFDIFLELF0F0N	Rotodisk™			

Dimensions

Ø (inches)	L (mm)	A (mm)	H (mm)	Weight (kg)
4"	1265	250	345	15,10
4"	1265	250	390	15,10
4"	1265	250	390	16,20

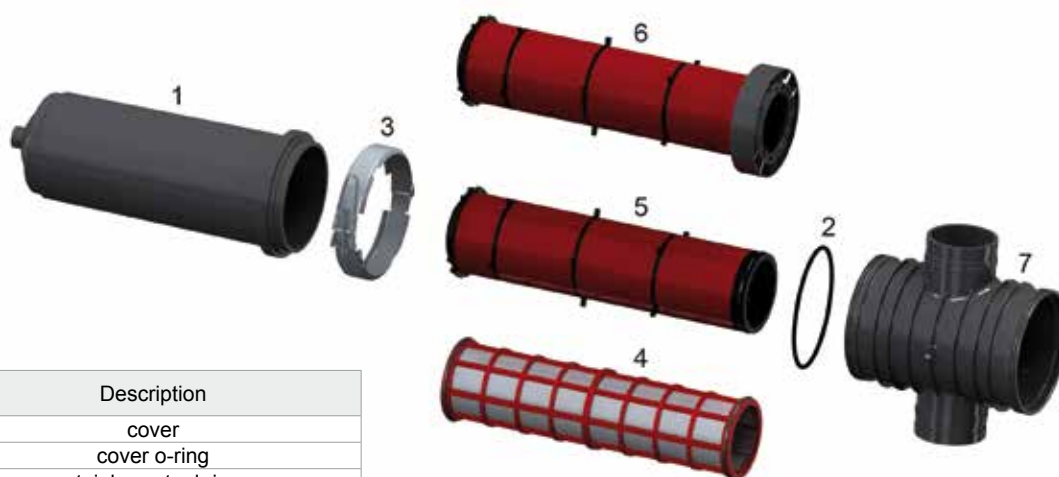
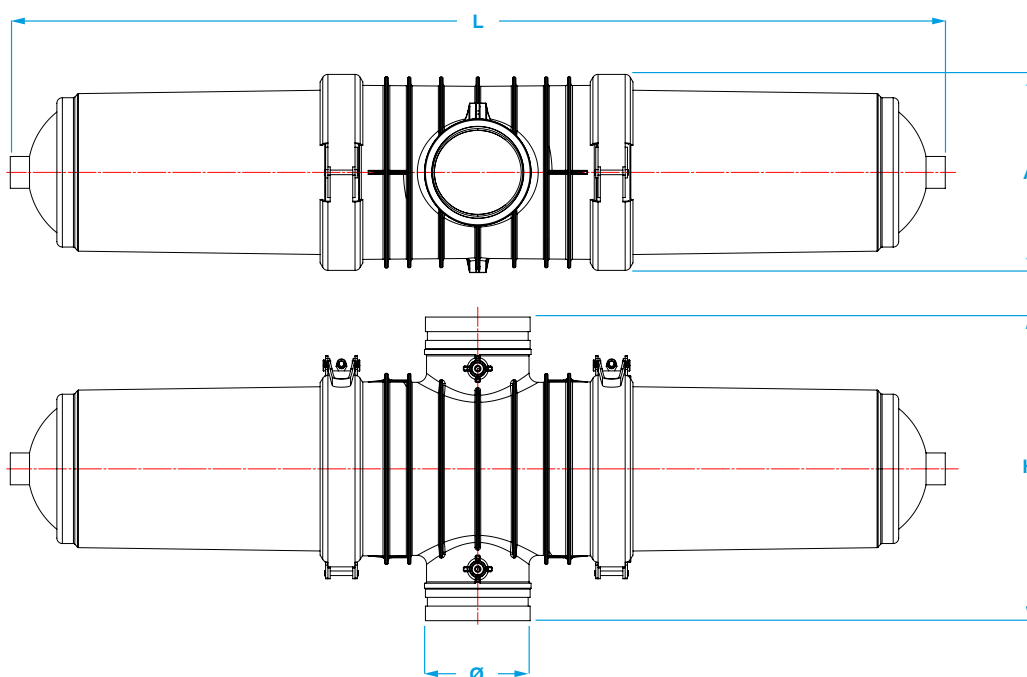

Components

Number	Description
1	cover
2	cover o-ring
3	stainless steel ring
4	complete stainless steel screen cartridge
5	complete stainless steel disk cartridge
6	Rotodisk® cartridge (with deflector)
7	twin filter body