

## EDV 90

### Applications

The EDV disk filter is used for filtering of water with small and medium sized suspended inorganic particles. The strong structure of the filtering cartridge inside, consisting of a parcel of stacked disks, minimises the risks of damage caused by overpressure or possible water hammer. It can be used both in agriculture and industry.

### Materials

- Body: in sanded metal treated with phosphate zinc and followed by an electrostatic application of a layer of polyester paint, minimum thickness 160 micron, with a protective and anti-corrosion function.
- Filtering element: polypropylene disks.
- Gaskets: EPDM.

### Characteristics

- Maximum working pressure: 8 bar
- Standard filtration grade: 120 mesh (filtration available: 80, 120, 150 mesh)
- Types of connection: threaded, flanged, victaulic
- The filter is supplied with a discharge valve



Filtering element

### Load loss\*

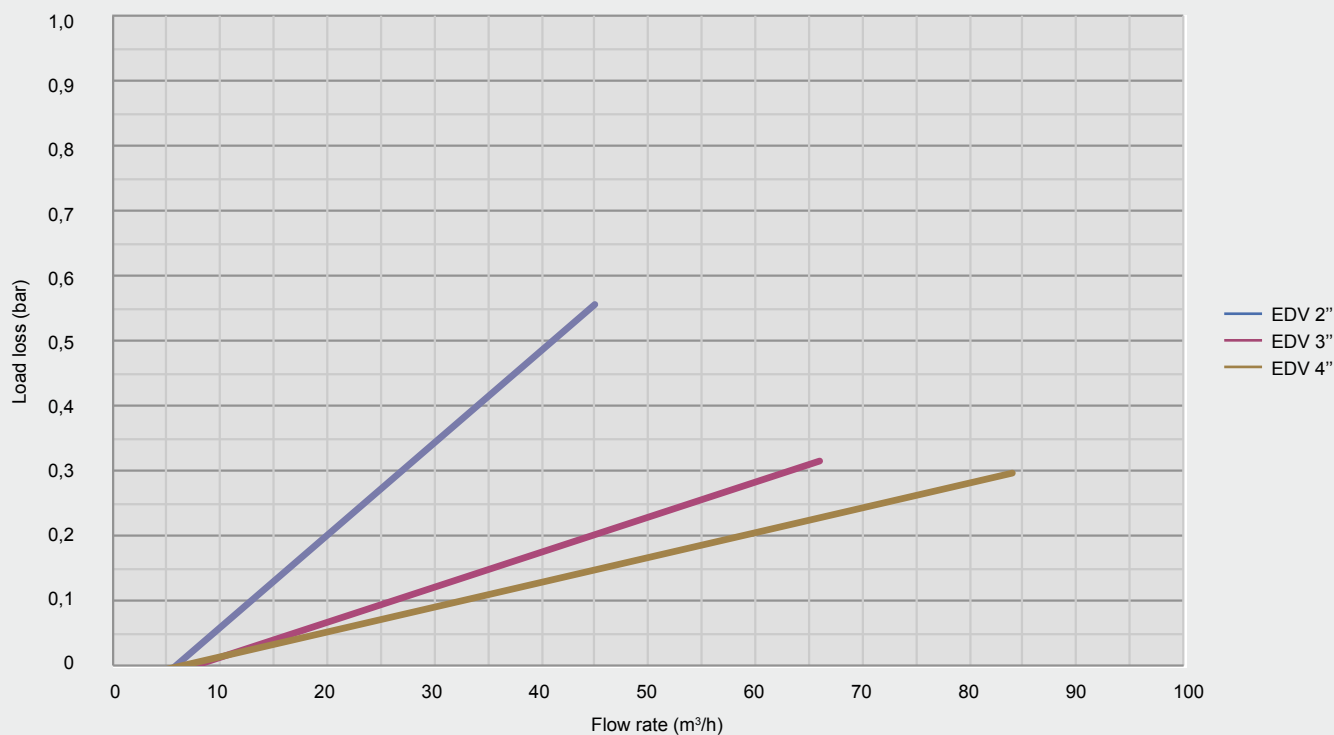

\*Testing for load loss was carried out with clean water.

# EDV 90

## Technical data

Connections	Pricelist ref.	Ø body (mm)	Flow rate (m³/h)	Filtration area (cm²)
2"	IFEDV9020H12	168,30	15 - 30	1196
3"	IFEDV9030H12	168,30	25 - 40	1402
4"	IFEDV9040H12	219,10	40 - 80	1868

Connection type: **H** female threaded; **F** flanged; **W** victaulic

## Dimensions

L (mm)	L1 (mm)	A (mm)	H (mm)	H1 (mm)	Ø (inches)	Ø1 (mm)	Weight (kg)	
							H - W	F
525	240	275	175	270	----	----	14	----
650	300	275	200	290	----	----	20	----
760	370	275	210	300	----	----	25	----

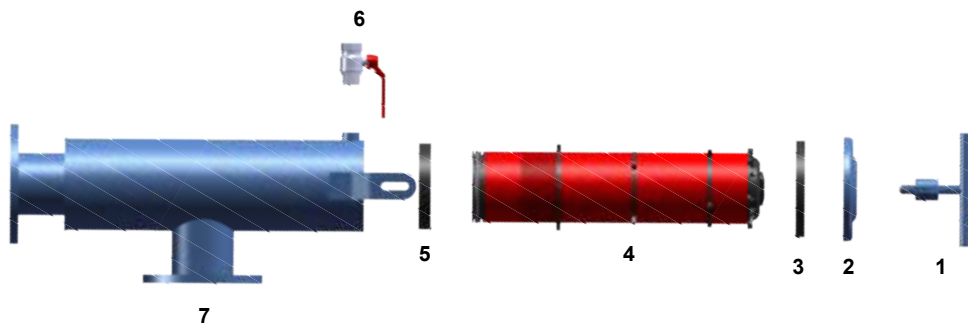
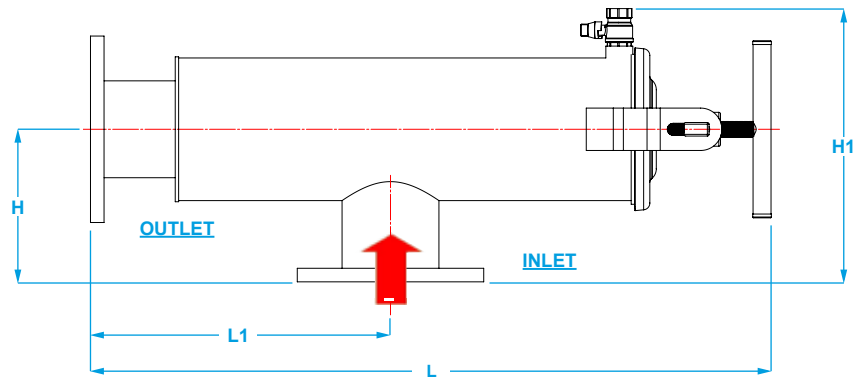
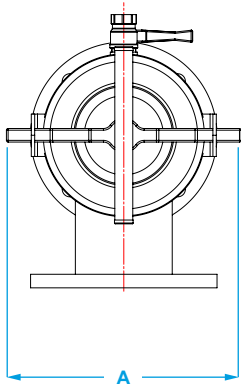

## Components

Number	Description
1	t-handle
2	cover
3	cover gasket
4	disk filtering cartridge
5	internal gasket
6	discharge valve
7	filter body