

EUV

Applications

EUV single chamber, quartzite sand filters are particularly suitable for the filtration of water with high amounts of organic substances: algae, mud and slimy particles of organic matrix. It is recommended for water from rivers, lakes or dams. The special diffusers (mushroom-shaped) located inside on the horizontal plate prevent the quartzite from becoming compact decreasing pressure loss of the whole system. EUV filters can be installed individually, or in two or more filters. Backwash can be manual or automatic.

Materials

- Body: in sanded metal treated with phosphate zinc and followed by an electrostatic application of a layer of polyester paint, minimum thickness 160 micron, with a protective and anti-corrosion function
- Gaskets: EPDM
- Diffuser nozzle: polypropylene (mushroom)

Characteristics

- Maximum working pressure: 8 bar
- Types of connection: threaded, flanged, victaulic
- The filter is supplied with a discharge valve and air release valve



EUV TYPE A



EUV TYPE B

Load loss*

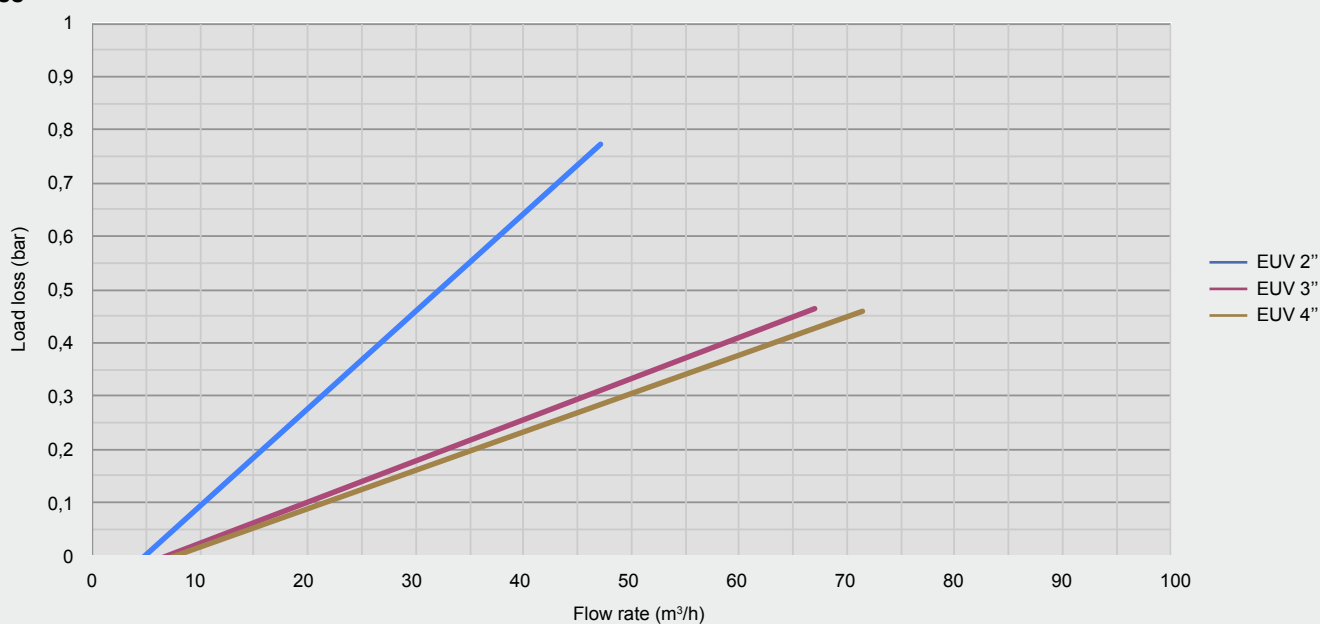

*Testing for load loss was carried out with clean water.

EUV

Technical data

Connections	Pricelist ref.	Ø body (mm)	Flow rate (m³/h)	Min. backw. flow rate (m³/h)
1 1/2"	IFEUV15H400	400	6 - 11	9
2"	IFEUV20H500	500	13 - 18	15
2"	IFEUV20H600	600	14 - 28	25
3"	IFEUV30H600	600	14 - 28	25
3"	IFEUV30H900	900	32 - 62	54
3"	IFEUV30F900	900	32 - 62	54
4"	IFEUV40H900	900	35 - 65	54
4"	IFEUV40F900	900	35 - 65	54
4"	IFEUV40H1200	1200	35 - 90	95
4"	IFEUV40F1200	1200	35 - 90	95

Connection type: **H** female threaded; **F** flanged; **W** victaulic

Dimensions

L (mm)	L1 (mm)	H (mm)	H1 (mm)	H2 (mm)	BD (mm)	Tipo	Weight (kg)	
							H - W	F
480	430	1020	270	670	400	A	----	----
650	530	1030	280	720	500	A	----	----
680	660	1060	280	730	600	A	66	----
680	660	1060	280	730	600	A	68	----
1100	----	1210	365	550	900	B	150	----
1060	----	1170	365	550	900	B	----	157
1100	----	1210	365	550	900	B	152	----
1060	----	1170	365	550	900	B	----	160
1360	----	1330	410	690	1200	B	230	----
1360	----	1310	410	690	1200	B	----	242

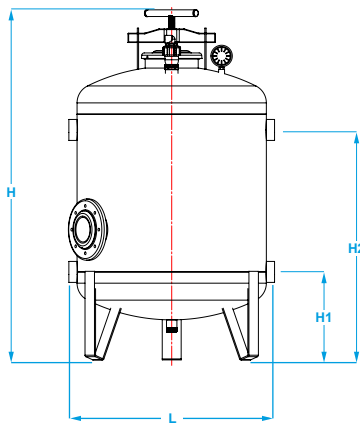

EUV TYPE A

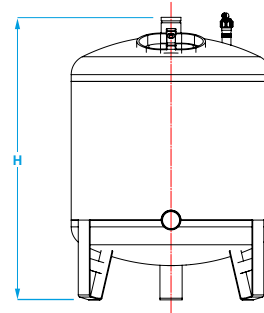
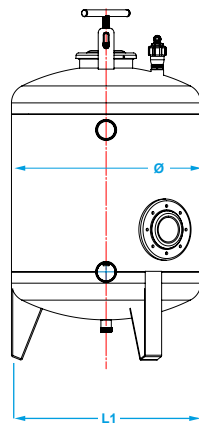

EUV TYPE B

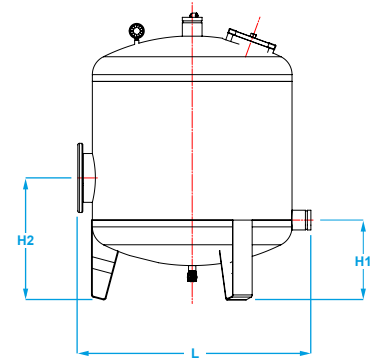

Components TYPE A

Number	Description
1	t-handle
2	cover for hatchway
3	gasket for hatchway
4	air release valve
5	purge valve
6	diffuser nozzle

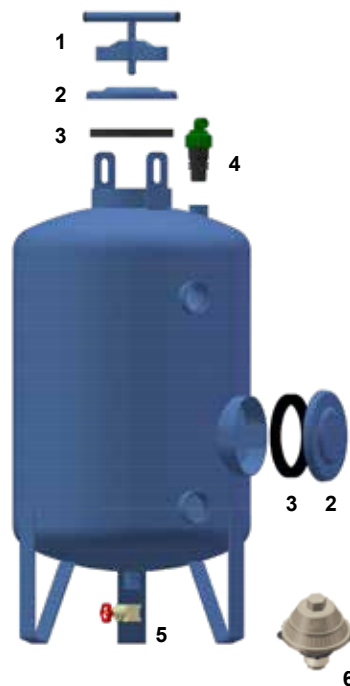

EUV TYPE A

Components TYPE B

Number	Description
1	air release valve
2	manometer
3	loading hatchway t-handle
4	loading hatchway gasket
5	loading hatchway cover
6	side discharge hatchway gasket
7	side discharge hatchway cover
8	lower discharge hatchway cover
9	lower discharge hatchway gasket
10	lower discharge hatch. purge valve
11	diffuser nozzle

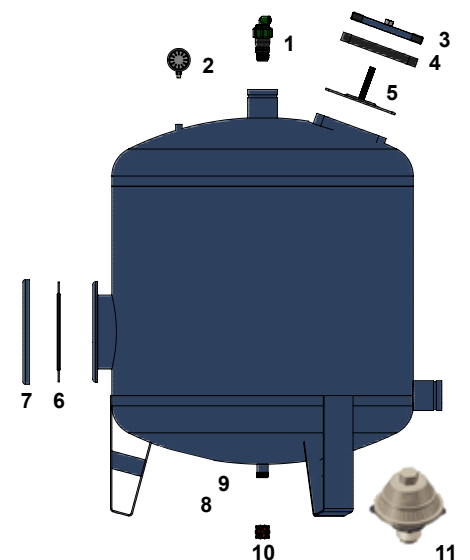

EUV TYPE B